

—le Corbusier: Top View—

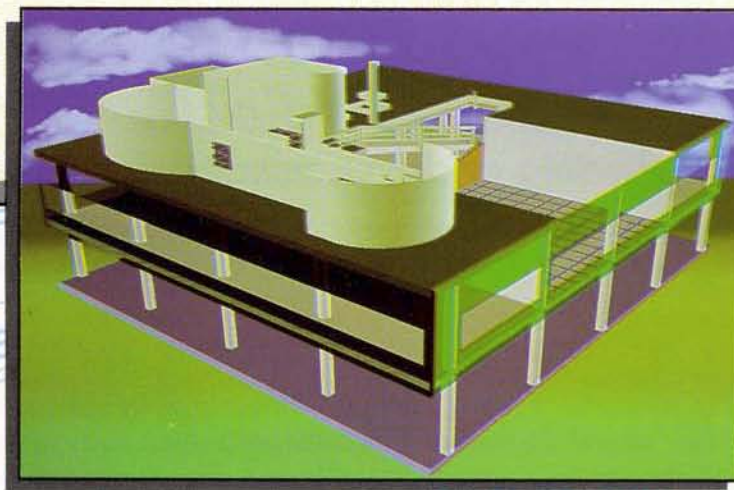

—Resolution: 4000 line—

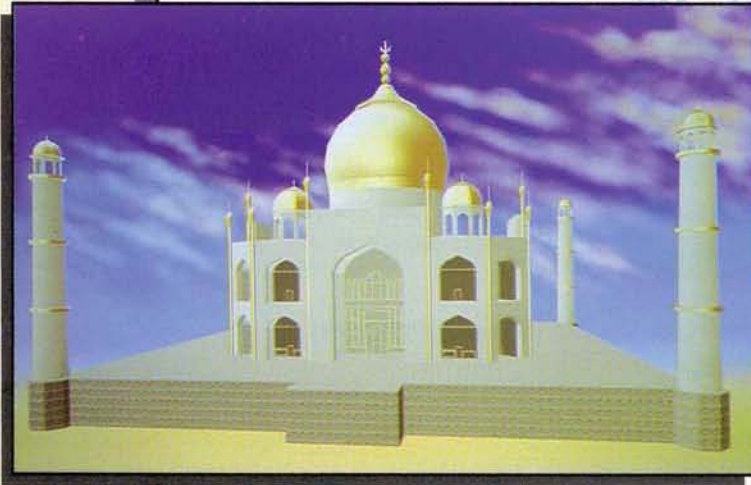

—Taj Mahal—



# Where Shading Ends... Rendering Begins.

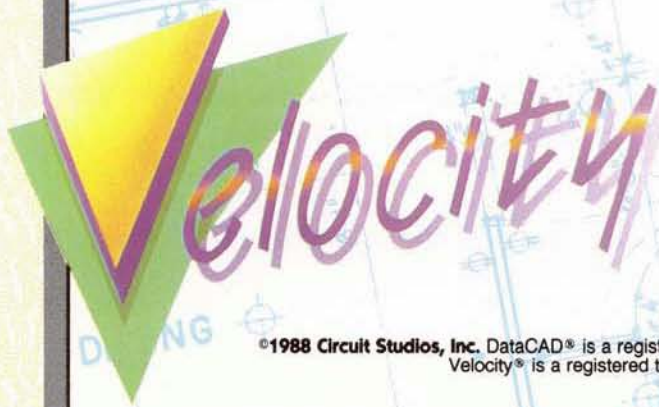

**DataCAD**  
Velocity 3-D Renderer

# DataCAD-Velocity

## Where shading ends . . . rendering begins

**DataCAD-Velocity**—the first photo realistic, high resolution, 3D solids rendering system for assigning real world surface attributes to all 3D wireframe drawings created within DataCAD's DC Modeler.

Now all DataCAD users, whether they are architects, engineers or construction professionals, can explore the realm of high-end solids rendering . . . within the familiar DataCAD menu structure.

Unlike many systems that only utilize flat shading, **DataCAD-Velocity** offers surfaces like plastics, metals and glass, which can actually display varying degrees of transparency. Textures such as wood, marble, brick and shingles are "mapped" onto the model's surface to achieve a new degree of realism for high-impact presentations.

## RENDERING vs. SHADING

<u>KEY FEATURES</u>	<b>DataCAD-Velocity</b>	<b>SHADING PROGRAMS</b>
<b>Degree of Photo Realism</b>	Is photo realistic. Offers a palette of 16.7 million surface color choices in 24 bit resolution.	Is not photo realistic. Limited to 256 color choices, in 8 bit color resolution.
<b>Surface Options</b>	Select real world materials such as plastics, metals, alloys—all with smooth shading, smooth edges and surface highlights.	Simple, flat colors.
<b>Texture Choices</b>	Offers real world surface textures such as wood, brick, marble, stone and shingles for high-impact presentations.	Most use "hatch" patterns for limited texturing.
<b>Transparent Glass</b>	Realistic glass . . . defines the degree of transparency to get smoked, clear or tinted glass.	No transparency.
<b>Lighting Specifications</b>	Multiple, user-defined lighting environments	Multiple, directional lights.
<b>Hard Copy and Print Output</b>	Direct output to the Hewlett Packard Paint Jet Printer and Calcomp 5835 Plotter. Also allows direct output of photo-realistic slides, transparencies, and color prints at 4,000 line resolution.	Limited output. None are photo-realistic.

Specifications: Supports a variety of IBM PCs and compatibles, utilizing an Artist 10, Verticom H256, VMI, VGA, or Velocity 16-bit video digitizing board. See your authorized DataCAD dealer for further details.

Suggested retail price: \$2,000.00.

Available through: MICROTECTURE CORPORATION, 1224 W. Main Street, 4th floor, Charlottesville, Virginia 22903  
1 (800) 722-3983; 1 (804) 295-2600 in Virginia